

# INSTRUCTIONS

## DRILL SIZE, CUTTING SPEED AND MATERIAL

When selecting a suitable model of drill for your application, it should be chosen on the basis of drill bit size and suitable cutting speed for the material to be drilled. The table below shows the recommended drill bit sizes for different speeds when drilling some common materials. The figures in the table are based on drill speeds at normal pressure and the minimum torque in conjunction with drill breakthrough. The table only shows which drill bit sizes give the cutting speeds within the ranges stated. Note that it is quite possible to drill with smaller diameter drill bits, i.e. at lower cutting speeds.

In order to obtain a sufficient cutting force when applying feed pressure by hand, pre-drilling is recommended for drill bit sizes above 8 mm when drilling in mild steel, soft cast iron, malleable iron as well as for holes larger than 6 mm in forged steel and stainless steel.

Fuji Drills are light weight with a sturdy construction. Their practical design represents Fuji's latest developments in drills technology. Fuji offers a complete line of drills with a drilling capacity range from 2 mm to 100 mm.

### Suggested Cutting Speed (min<sup>-1</sup>) for Drilling

Material	Stainless Steel	Forged Steel	Mild Steel	Soft Cast Iron	Malleable Iron	Brass or Bronze	Aluminum	Magnesium	Plastic	Wood	Titanium
Drill bit size <small>(Cutting speed in m/min)</small>	9-12	12-15	24-33	30-45	24-27	60-90	60-90	75-120	30-45	90-120	15-18
3 mm	1100	1400	3000	4000	2700	8000	8000	10400	4000	11000	1750
4 mm	840	1100	2200	3000	2000	6000	6000	7800	3000	8400	1300
5 mm	660	860	1800	2400	1600	4800	4800	6200	2400	6700	1050
6 mm	550	700	1500	2000	1350	4000	4000	5200	2000	5600	880
8 mm	420	540	1100	1500	1000	3000	3000	3900	1500	4200	660
10 mm	330	430	900	1200	800	2400	2400	3100	1200	3300	630
12 mm	280	350	750	1000	700	2000	2000	2600	1000	2800	440
13 mm	260	330	700	920	630	1800	1800	2400	920	2550	400
14 mm	240	300	640	850	580	1700	1700	2200	850	2400	370
16 mm	210	270	560	750	500	1500	1500	1950	750	2100	330
19 mm	180	230	480	630	430	1250	1250	1600	630	1800	280
22 mm	150	200	410	540	370	1100	1100	1400	540	1500	240
23 mm	140	190	390	520	350	1000	1000	1350	520	1450	230
25 mm	130	170	360	480	320	960	960	1250	480	1330	210
28 mm	120	150	320	420	290	850	850	1100	420	1200	190
32 mm	100	130	280	380	250	750	750	980	380	1050	160
44 mm	75	100	210	270	180	550	550	700	270	750	120
50 mm	65	85	180	240	160	480	480	620	240	670	110
75 mm	44	57	120	160	110	320	320	420	160	450	70
100 mm	33	43	90	120	80	240	240	310	120	330	55

## DRILLS FEATURES

### REVERSIBLE



Fuji offer some reversible drills. The reverse action is selected by simply turning the reverse lever.



### PLASTIC COVER

The plastic cover softens the effect of vibration during the drilling application and creates a "warm to touch" feeling to improve operator comfort.

### TWO-STAGE THROTTLE ACTUATION



This mechanism allows slow start smooth operation to full speed allowing the drill bit to be centralised prior to drilling at full speed.



### DEAD HANDLE

The dead handle helps to soften the breakthrough reaction force experienced when drilling "tough holes".



### SWIVEL TYPE EXHAUST COVER

The exhaust cover can be rotated to enable the operator to choose a convenient direction of the exhaust air.



### SELF-RETURN ROLL HANDLE

When the operator releases the handle, it automatically returns to the "OFF" position and the air supply is switched off. When ordering, add "S" to the end of the model name.



### REAR EXHAUST WITH BUILT-IN MUFFLER

The noise level is minimised via the muffler built into the exhaust cover.



### LOCKING HANDLE

The locking handle is designed to reduce the risk of inadvertent starting of the drill. The handle reverts automatically to the locked position when released.

### JACOBS TAPERED MODELS WITH YUKIWA CHUCK

Fuji offer special models with Jacobs tapered spindles and chucks for very precise drilling application.

Especially FRD-6PH series provides run-out (0.02mm for FRD-6PH-2 & 3, 0.06mm for FRD-6PH-5 & 7)

For more versatile applications the series provides 3/8"-24 spindles models (FRD-6PH TH).



FRD-6PH-3



Yukiwa tapered chucks



FRD-6PH-5

## STRAIGHT TYPE

FRD-5S



FRD-6S



## GLOBAL SPECIFICATIONS

Model		Drilling Capacity		Stall Torque		Free Speed	Type and Size of Spindle		Chuck Capacity	Side to Center			Power		Overall Length		Weight		Max. Air Consumption		Air Hose Size	
Thread Type	Taper Type	mm	in	N.m	ft.lb	min <sup>-1</sup>	Thread	Taper	mm	mm	in	W	hp	mm	in	kg	lb	m <sup>3</sup> /min	ft <sup>3</sup> /min	mm	in	
FRD-5S-1		5	3/16	2	1.5	3200	3/8-24UNF		6.5	18.5	3/4	180	0.24	188	7.4	0.6	1.32	0.60	21.2	6.3	1/4	
	FRD-5S-2T	5	3/16	0.3	0.2	24000		Jacobs Taper D	5	18.5	3/4	180	0.24	174	6.85	0.5	1.1	0.60	21.2	6.3	1/4	
	FRD-6S-1T	3	1/8	0.6	0.44	21000		Jacobs Taper 1	6.5	21	17/20	290	0.39	177	6.97	0.7	1.52	0.54	19.2	9.5	3/8	
FRD-6S-2		5	3/16	2.5	1.8	4300	3/8-24UNF		6.5	21	17/20	290	0.39	209	8.23	0.9	1.98	0.68	24	9.5	3/8	
FRD-6S-3		8	5/16	2.9	2.1	2800	3/8-24UNF		8	21	17/20	290	0.39	218	8.56	1	2.21	0.68	24	9.5	3/8	
FRD-6S-5		10	7/16	7	5.2	1300	3/8-24UNF		10	23	29/32	290	0.39	237	9.31	1.1	2.43	0.68	24	9.5	3/8	
● FRD-6S-7		13	1/2	16	11.8	600	1/2-20UNF		13	21	17/20	290	0.39	271	10.7	1.7	3.75	0.68	24	9.5	3/8	

\* Marked ● are furnished with Dead Handle

## TOOL SELECTION GUIDE

### Standard models

Model	Throttle	
	Lever	Locking Lever (F)
FRD-5S-1 E	541 205 3306	541 207 2178
FRD-5S-2T	541 205 3310	
FRD-6S-1T	541 207 2214	
FRD-6S-2 E	541 205 3331	541 205 3332
FRD-6S-3 E	541 205 3337	541 205 3340
FRD-6S-5 E	541 205 3343	541 205 3346
FRD-6S-7 E	541 205 3348	541 205 3350

### CE certified models

Model	Throttle
	Locking Lever (F)
FRD-5S-1F EC	541 207 2179
FRD-6S-2F EC	541 207 2216
FRD-6S-3F EC	541 207 2221
FRD-6S-6F EC	541 207 2225
FRD-6S-7F EC	541 207 2229

For CE region availability of non CE models, please inquire to your Fuji representative.

### NPT models

Model	Throttle
	Lever
FRD-5S-2T N	541 205 3311
FRD-6S-3 N	541 205 3335

For possibility of NPT inlet for other models, please inquire to your Fuji representative.

## ACCESSORIES

### DRILL CHUCKS



AC Number	Part Number	Models	Chuck Capacity	Type and Size of Spindle
DCK-5J	541 205 2006	FRD-5S-2T	5mm	J.T.#D
DCK-6.5	541 205 2007	FRD-5S-1 series, 5P-1 series, 6S-2 series, 6PH-2 series	6.5mm	3/8"-24 (Thread)
DCK-6.5J	541 205 2009	FRD-6PH-3 series	6.5mm	J.T.#1
DCK-8	541 205 2010	FRD-8PX-1 series	8mm	3/8"-24 (Thread)
DCK-8J	541 205 2011	FRD-6PH-3 series	8mm	J.T.#1
DCK-10	541 205 1997	FRD-8PX-2 series	10mm	3/8"-24 (Thread)
DCK-10J	541 205 2000	FRD-6PH-5 series	10mm	J.T.#2S
DCK-13	541 205 2001	FRD-8PX-3 series	13mm	1/2"-20 (Thread)
DCK-13J	541 205 2003	FRD-6PH-7 series	13mm	J.T.#6
DCK-16	541 205 2004	FRD-16Z series	16mm	5/8"-16 (Thread)

# DRILLS

## PISTOL/REAR EXHAUST TYPE



FRD-6PH-3



FRD-6PH-7



FRD-8PX

## GLOBAL SPECIFICATIONS

Model		Drilling Capacity		Stall Torque		Free Speed		Type and Size of Spindle		Chuck Capacity		Side to Center		Power		Overall Length		Weight		Max. Air Consumption		Air Hose Size	
Thread Type	Taper Type	mm	in	N.m	ft.lb	min <sup>-1</sup>	Thread	Taper	mm	mm	in	W	hp	mm	in	kg	lb	m <sup>3</sup> /min	ft <sup>3</sup> /min	mm	in		
FRD-5P-1		5	3/16	2	1.5	3200	3/8-24UNF		6.5	18	18/25	180	0.24	155	6.1	0.6	1.32	0.40	14.1	6.3	1/4		
	FRD-6PX-1T	3	1/8	0.6	0.44	21000		Jacobs Taper 1	6.5	21	17/20	290	0.39	182	7.17	1	2.21	0.68	24	9.5	3/8		
FRD-6PH-2 TH	FRD-6PH-2	5	3/16	2.7	2	4300	3/8-24UNF	Jacobs Taper 1	6.5	21	0.85	340	0.46	198	7.8	0.9	1.98	0.58	20.6	9.5	3/8		
FRD-6PH-3 TH	FRD-6PH-3	6.5	1/4	4.3	3.2	2800	3/8-24UNF	Jacobs Taper 1	6.5	21	0.85	340	0.46	198	7.8	0.89	1.96	0.58	20.6	9.5	3/8		
FRD-6PH-3 8 TH	FRD-6PH-3 8	8	5/16	4.3	3.2	2800	3/8-24UNF	Jacobs Taper 1	8	21	0.85	340	0.46	198	7.8	0.89	1.96	0.58	20.6	9.5	3/8		
● FRD-6PH-5 TH	● FRD-6PH-5	10	7/16	7.5	5.5	1300	3/8-24UNF	Jacobs Taper 2S	10	21	0.85	320	0.43	243	9.54	1.4	3.09	0.58	20.6	9.5	3/8		
● FRD-6PH-7 TH	● FRD-6PH-7	13	1/2	15.8	11.7	600	1/2-20 UNF	Jacobs Taper 6	13	22.5	0.9	320	0.43	258	10.1	1.5	3.31	0.58	20.6	9.5	3/8		
FRD-8PX-1		8	5/16	5.9	4.4	2600	3/8-24UNF		8	25	1	440	0.59	198.5	7.81	1.7	3.75	0.76	26.8	9.5	3/8		
● FRD-8PX-2		10	7/16	12	8.9	1300	3/8-24UNF		10	26.5	1 1/10	440	0.59	220	8.64	2.1	4.63	0.76	26.8	9.5	3/8		
● FRD-8PX-3		13	1/2	20	14.8	900	1/2-20UNF		13	25.5	1	400	0.54	253.5	9.95	2.9	6.39	0.76	26.8	9.5	3/8		

\* Marked ● are furnished with Dead Handle

## TOOL SELECTION GUIDE

### Standard models

Model	Jacobs Taper Models	Threaded Models (TH)	
		with chuck	without chuck (W/O C)
FRD-5P-1		541 205 3302	
FRD-6PX-1T	541 207 2192		
FRD-6PH-2	541 207 7834	541 210 4338	541 210 4359
FRD-6PH-3	541 207 2186	541 210 4341	541 210 4362
FRD-6PH-3 8	541 207 2187	541 210 4344	
FRD-6PH-5	541 207 2188	541 210 4347	541 210 4365
FRD-6PH-7	541 207 2190	541 210 4350	541 210 4368
FRD-8PX-1		541 205 3363	
FRD-8PX-2		541 205 3366	
FRD-8PX-3		541 205 3368	

### CE certified models

Model	Jacobs Taper Models	Threaded Models (TH)	
		with chuck	without chuck (W/O C)
FRD-5P-1		541 207 2176	
FRD-6PH-2	541 210 3166	541 210 4339	541 210 4360
FRD-6PH-3 8		541 210 4345	
FRD-6PH-3	541 210 3169	541 210 4342	541 210 4363
FRD-6PH-5	541 210 3147	541 210 4348	541 210 4366
FRD-6PH-7	541 210 3170	541 210 4351	541 210 4369
FRD-8PX-1		541 207 2236	
FRD-8PX-2		541 207 2238	541 207 2239
FRD-8PX-3		541 207 2241	541 207 2242

For CE region availability of non CE models. Please inquire to your Fuji representative.

### NPT models

Model	Jacobs Taper Models	Threaded Models (TH)	
		with chuck	without chuck (W/O C)
FRD-5P-1		541 205 3301	
FRD-6PH-2	541 210 2865	541 210 4340	541 210 4361
FRD-6PH-3 8	541 210 3221	541 210 4346	
FRD-6PH-3	541 207 8455	541 210 4343	541 210 4364
FRD-6PH-5	541 207 8454	541 210 4349	541 210 4367
FRD-6PH-7	541 207 8453	541 210 4352	541 210 4370
FRD-8PX-1		541 205 3361	
FRD-8PX-2		541 205 3364	
FRD-8PX-3		541 205 3367	

For possibility of NPT inlet for other models, please inquire to your Fuji representative.



## GRIP HANDLE MEDIUM SIZE DRILLS



FRD-12Z-1~16Z-1  
(OUTSIDE LEVER)



FRD-12Z-1C~16Z-1C  
(INSIDE LEVER)

### GLOBAL SPECIFICATIONS

Model	Drilling Capacity		Stall Torque		Free Speed	Type and Size of Spindle		Chuck Capacity		Side to Center		Power		Overall Length		Weight		Max. Air Consumption		Air Hose Size	
	mm	in	N.m	ft.lb	min <sup>-1</sup>	Thread	Taper	mm	in	W	hp	mm	in	kg	lb	m <sup>3</sup> /min	ft <sup>3</sup> /min	mm	in		
FRD-12Z-1	12	1/2	22	16.2	1200	1/2-20UNF	-	13	34	1 11/32	660	0.88	372	14.6	3.3	7.28	1.20	42.4	12.7	1/2	
FRD-16Z-1	16	5/8	34.3	25.3	800	5/8-16UNF	-	16	34	1 11/32	660	0.88	364	14.3	3.7	8.16	1.20	42.4	12.7	1/2	

### TOOL SELECTION GUIDE

#### Standard models

Model	Trigger	
	Outside trigger	Inside trigger (C)
FRD-12Z-1 E	541 205 3255	
FRD-12Z-1C E		541 205 3257
FRD-16Z-1 E	541 205 3261	
FRD-16Z-1C E		541 205 3264

#### CE certified models

Model	Trigger	
	Outside trigger	Inside trigger (C)
FRD-12Z-1C EC	541 207 2133	
FRD-16Z-1C EC	541 207 2139	

For CE region availability of non CE models, please inquire to your Fuji representative.

#### NPT models

Model	Trigger	
	Outside trigger	Inside trigger (C)
FRD-12Z-1 N	541 205 3253	
FRD-16Z-1 N	541 205 3259	
FRD-16Z-1C N		541 205 3262

For possibility of NPT inlet for other models, please inquire to your Fuji representative.

## HEAVY-DUTY DRILLS



FRD-40R~50R~65R



FRD-20R~32R



FRD-75R~100R

### GLOBAL SPECIFICATIONS

Model	Drilling Capacity		Reaming Tapping		Stall Torque		Free Speed	Socket	Feed Length		Power		Overall Length		Weight		Max. Air Consumption		Air Hose Size	
	mm	in	mm	in	N.m	ft.lb	min <sup>-1</sup>	M.T.#	mm	in	W	hp	mm	in	kg	lb	m <sup>3</sup> /min	ft <sup>3</sup> /min	mm	in
FRD-20R-21	19	3/4	16	5/8	63.7	47	600	2	67	2.64	880	1.18	282	11.1	7	15.4	1.20	42.4	12.7	1/2
FRD-20R-22	19	3/4	16	5/8	63.7	47	600	3	67	2.64	880	1.18	307	12.1	7	15.4	1.20	42.4	12.7	1/2
FRD-23R-21	22	7/8	19	3/4	78.4	57.8	480	2	67	2.64	880	1.18	282	11.1	7.3	16.1	1.20	42.4	12.7	1/2
FRD-23R-22	22	7/8	19	3/4	78.4	57.8	480	3	67	2.64	880	1.18	307	12.1	7.4	16.3	1.20	42.4	12.7	1/2
FRD-25R-11	25	1	22	7/8	147	108	530	3	96	3.78	2100	2.81	353	13.9	14	30.8	3.20	113	19	3/4
FRD-28R-11	28	1 1/8	25	1	177	130	430	3	96	3.78	2100	2.81	353	13.9	14	30.8	3.20	113	19	3/4
FRD-32R-11	32	1 1/4	25	1	196	145	380	3	96	3.78	2100	2.81	353	13.9	14.5	31.9	3.20	113	19	3/4
FRD-32R-12	32	1 1/4	25	1	196	145	380	4	96	3.78	2100	2.81	353	13.9	14.5	31.9	3.20	113	19	3/4
FRD-40R-11	44	1 3/4	32	1 1/4	304	224	220	4	93	3.66	1800	2.41	446	17.6	18.7	41.1	3.20	113	19	3/4
FRD-50R-11	50	2	50	2	431	318	150	4	93	3.66	1800	2.41	446	17.6	18.7	41.1	3.20	113	19	3/4
FRD-65R-1	65	2 9/16	65	2 9/16	608	448	190	5	125	4.92	3300	4.42	487	19.2	32	70.4	5.50	194.2	25.4	1
FRD-75R-1	75	3	75	3	1156	1156	85	5	128	5.04	3100	4.15	600	23.6	43	94.6	5.50	194.2	25.4	1
FRD-100R-1	100	4	100	4	1823	1345	55	5	128	5.04	3100	4.15	600	23.6	43	94.6	5.50	194.2	25.4	1

### TOOL SELECTION GUIDE

#### Standard models

Model	Handle	
	Normal roll handle	Self return type (S)
FRD-20R-21	541 205 3265	541 205 3267
FRD-20R-22	541 205 3269	541 205 3271
FRD-23R-21	541 205 3273	541 205 3275
FRD-23R-22	541 205 3277	541 205 3279
FRD-25R-11	541 205 3282	541 205 3284
FRD-28R-11		541 205 3288
FRD-32R-11	541 205 3290	541 205 3292
FRD-32R-12	541 205 3294	541 205 3296
FRD-40R-11	541 205 3298	541 205 3300
FRD-50R-11	541 205 3313	541 205 3315
FRD-65R-1	541 205 3353	541 205 3355
FRD-75R-1 E	541 205 3358	541 205 3359
FRD-100R-1 E	541 205 3250	

#### CE certified models

Model	Handle	
	Outside trigger	Self return type (S)
FRD-20R-21S EC	541 207 2141	
FRD-20R-22S EC	541 207 2143	
FRD-23R-21S EC	541 207 2148	
FRD-23R-22S EC	541 207 2150	
FRD-25R-11S EC	541 207 2154	
FRD-28R-11S EC	541 207 2157	
FRD-32R-11S EC	541 207 2161	
FRD-32R-12S EC	541 207 2165	
FRD-40R-11S EC	541 207 2168	
FRD-50R-11S EC	541 207 2172	
FRD-65R-1S EC	541 207 2182	
FRD-75R-1S EC	541 207 2234	

For CE region availability of non CE models, please inquire to your Fuji representative.

#### NPT models

Model	Handle	
	Outside trigger	Self return type (S)
FRD-20R-21 N	541 205 3268	
FRD-20R-22 N	541 205 3272	
FRD-23R-21 N	541 205 3276	
FRD-23R-22 N	541 205 3280	
FRD-50R-11 N	541 205 3314	
FRD-75R-1 N	541 205 3360	

For possibility of NPT inlet for other models, please inquire to your Fuji representative.

# BABY ANGLE DRILLS

## BABY ANGLE DRILLS

Fuji Baby Angle Drills are equipped with a compact head (low height and side-to-center head dimensions) to allow these tools to be used in confined areas. Ball and needle bearings used throughout angle heads provide long service life and less spindle run-out.



FCD-6A-1



FCD-6B-1



FCD-6EX-3



FCD-6EX-4

### SNAKE DRILLS (SN-2~6)



Thread 1/4-28

### DRILL CHUCKS (CN-1802-1808)



Thread 1/4-28

Snake Drill Bits 2mm to 6mm and Drill Chuck capacities 1/16" to 1/4" are available on request

## GLOBAL SPECIFICATIONS

Model	Drilling Capacity		Stall Torque		Free Speed	Spindle Thread Size	Side to Center		Power		Overall Length		Weight		Max. Air Consumption		Air Hose Size	
	mm	in	N.m	ft.lb	min <sup>-1</sup>	in	mm	in	W	hp	mm	in	kg	lb	m <sup>3</sup> /min	ft <sup>3</sup> /min	mm	in
<b>Front Exhaust Type</b>																		
FCD-6A-1	6	1/4	2.5	1.8	2500	1/4-28UNF	9.5	3/8	160	0.21	223	8.76	0.6	1.32	0.56	19.8	6.3	1/4
FCD-6B-1	6	1/4	2.5	1.8	2500	1/4-28UNF	9.5	3/8	160	0.21	222	8.72	0.6	1.32	0.56	19.8	6.3	1/4
<b>Rear Exhaust Type</b>																		
FCD-6EX-3	6	1/4	2.9	2.1	3500	1/4-28UNF	8.5	11/32	270	0.36	246	9.66	0.69	1.52	0.76	26.9	6.3	1/4
FCD-6EX-4	6	1/4	2.9	2.1	3500	1/4-28UNF	8.5	11/32	270	0.36	246	9.66	0.69	1.52	0.76	26.9	6.3	1/4

Air Inlet Thread Size: PT 1/4"

## TOOL SELECTION GUIDE

### Standard models

Model	Throttle Type		
	Button	Lever	Locking Lever (F)
FCD-6A-1 E	541 205 2522		
FCD-6B-1 E		541 205 2523	541 205 2526
FCD-6EX-3	541 205 2527		
FCD-6EX-4		541 205 2529	541 205 2531

### CE certified models

Model	Throttle Type	
	Locking Lever (F)	
FCD-6B-1F EC	541 207 1265	

For CE region availability of non CE models, please inquire to your Fuji representative.

### NPT models

Model	Throttle Type	
	Lever (F)	
FCD-6EX-4 N	541 205 2530	

For possibility of NPT inlet for other models, please inquire to your Fuji representative.

## CORNER DRILLS

Fuji utilizes their power transmission knowledge in their line of corner drills. In addition to their power, these drills are designed to work well in confined spaces.



FCD-6X-1, 2

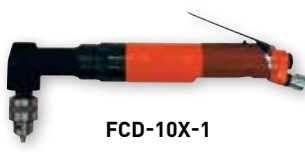

FCD-10X-1



FCD-6X-1F, 2F



FCD-10X-1F

## GLOBAL SPECIFICATIONS

Model	Drilling Capacity		Stall Torque		Free Speed	Spindle Thread Size	Side to Center		Power		Overall Length		Weight		Max. Air Consumption		Air Hose Size	
	mm	in	N.m	ft.lb	min <sup>-1</sup>	in	mm	in	W	hp	mm	in	kg	lb	m <sup>3</sup> /min	ft <sup>3</sup> /min	mm	in
FCD-6X-1	6	1/4	4.9	3.6	2500	3/8-24UNF	21	17/20	290	0.39	267	10.5	1.7	3.75	0.68	24	9.5	3/8
FCD-6X-2	6	1/4	7.8	5.7	1500	3/8-24UNF	21	17/20	290	0.39	281	11.1	1.9	4.19	0.68	24	9.5	3/8
FCD-10X-1	10	7/16	11.8	8.6	1200	1/2-20UNF	21	17/20	420	0.56	377	14.8	2.2	4.85	0.50	17.6	9.5	3/8
FCD-10X-1 13 N	10	7/16	11.8	8.6	1200	1/2-20UNF	21	17/20	420	0.56	377	14.8	2.2	4.85	0.50	17.6	9.5	3/8

## TOOL SELECTION GUIDE

### Standard models

Model	Throttle Type	
	Lever	Locking Lever (F)
FCD-10X-1 E	541 205 2497	541 205 2500
FCD-6X-1 E	541 205 2534	541 205 2536
FCD-6X-2 E	541 205 2539	541 205 2541

### CE certified models

Model	Throttle Type	
	Locking Lever (F)	
FCD-6B-1F EC	541 207 1265	
FCD-6X-1F EC	541 210 3012	
FCD-6X-2F EC	541 207 1273	
FCD-10X-1F EC	541 207 1242	

For CE region availability of non CE models, please inquire to your Fuji representative.

### NPT models

Model	Throttle Type	
	Lever	Locking Lever (F)
FCD-6X-1F N	541 205 2535	
FCD-10X-1F N	541 205 2498	
FCD-10X-1 13 N	541 210 2620	

For possibility of NPT inlet for other models, please inquire to your Fuji representative.



## HEAVY-DUTY CORNER DRILLS (NON-REVERSIBLE)



### GLOBAL SPECIFICATIONS

Model	Drilling Capacity		Reaming Tapping		Stall Torque		Free Speed	Socket	Side to Center		Feed Length		Power		Overall Length		Weight		Max. Air Consumption		Air Hose Size	
	mm	in	mm	in	N.m	ft.lb	min <sup>-1</sup>	M.T.#	mm	in	mm	in	W	hp	mm	in	kg	lb	m <sup>3</sup> /min	ft <sup>3</sup> /min	mm	in
F-14CN	14	9/16	9.5	3/8	31.4	23.1	1000	1	24	15/16	38	1.5	740	0.73	410	16.1	4.6	10.1	1.25	44.1	12.7	1/2
F-14CN-2	14	9/16	9.5	3/8	31.4	23.1	1000	2	24	15/16	38	1.5	740	0.73	410	16.1	4.6	10.1	1.25	44.1	12.7	1/2
F-22RCN	22	7/8	19	3/4	108	79.5	450	3	35	1 3/8	60	2.36	1100	1.48	493	19.4	8.5	18.7	1.50	53	12.7	1/2
F-32RCNS	32	1 1/4	25	1	127	94	400	3	40	1 3/5	25	0.98	1100	1.48	529	20.8	8.8	19.3	1.50	53	12.7	1/2

### TOOL SELECTION GUIDE

#### Standard models

Model	Handle	
	Normal roll handle	Self return type (S)
F-14CN E	541 205 2073	
F-14CN-1S		541 205 2074
F-14CN-2 E	541 205 2077	
F-14CN-2S		541 205 2078
F-22RCN E	541 205 2089	
F-22RCN-1S		541 205 2090
F-32RCN E	541 205 2106	
F-32RCN-1S		541 205 2107
F-32RCNS E		541 205 2110

#### CE certified models

Model	Handle
	Self return type (S)
F-14CN-1S EC	541 207 1001
F-14CN-2S EC	541 207 1003
F-22RCN-1S EC	541 207 1013
F-32RCN-1S EC	541 207 1020
F-32RCNS-1S EC	541 207 1022

For CE region availability of non CE models, please inquire to your Fuji representative.

#### NPT models

Model	Handle
	Self return type (S)
F-14CN-1S N	541 205 2075

For possibility of NPT inlet for other models, please inquire to your Fuji representative.

## HEAVY-DUTY CORNER DRILLS (REVERSIBLE)

Model	Drilling Capacity		Reaming Tapping		Stall Torque		Free Speed	Socket	Side to Center		Feed Length		Power		Overall Length		Weight		Max. Air Consumption		Air Hose Size	
	mm	in	mm	in	N.m	ft.lb	min <sup>-1</sup>	M.T.#	mm	in	mm	in	W	hp	mm	in	kg	lb	m <sup>3</sup> /min	ft <sup>3</sup> /min	mm	in
F-22RCR	22	7/8	19	3/4	93.2	68.7	400	2	35	1 3/8	60	2.36	900	1.2	505	19.9	8.5	18.7	1.50	53	12.7	1/2
F-32RCR	32	1 1/4	25	1	113	83.1	315	3	40	1 3/5	60	2.36	960	1.28	538	21.2	10	22	1.50	53	12.7	1/2
FCD-23R-12	22	7/8	19	3/4	80.4	59.3	430	2	27	1 1/16	35	1.38	900	1.2	472	18.6	7.1	15.6	1.50	53	12.7	1/2
FCD-23R-11	22	7/8	19	3/4	80.4	59.3	430	3	27	1 1/16	35	1.38	900	1.2	472	18.6	7	15.4	1.50	53	12.7	1/2
FCD-32R-11	32	1 1/4	32	1 1/4	177	130	350	3	35	1 3/8	53	1.38	1600	2.14	578	22.8	13.5	29.7	1.80	63.5	12.7	1/2
FCD-50R-11	50	2	50	2	392	289	140	4	41	1 5/8	58	1.38	1600	2.14	595	23.4	16	35.3	2.25	79.4	19	3/4
FCD-75R-11	75	3	75	3	834	615	85	5	49	1 15/16	57	2.24	1900	2.56	651	25.6	20.5	45.1	2.50	88.3	19	3/4
FCD-100R-11	100	4	100	4	1370	1013	40	5	62	2 7/16	105	4.13	1600	2.17	730	28.7	29.3	64.4	2.25	79.4	19	3/4



F-22RCR.S



F-32RCR.S



FCD-23R-50R.S



FCD-75R, 100R.S

### TOOL SELECTION GUIDE

#### Standard models

Model	Handle	
	Normal roll handle	Self return type (S)
F-22RCR-1S		541 205 2094
F-22RCR E	541 205 2093	
F-32RCR-1S		541 205 2115
F-32RCR E	541 205 2114	
FCD-75R-11 E	541 205 2544	541 205 2546
FCD-50R-11 E	541 205 2518	541 205 2520
FCD-32R-11 E	541 205 2514	541 205 2516
FCD-23R-12 E	541 205 2510	541 205 2512
FCD-23R-11 E	541 205 2506	541 205 2508
FCD-100R-11 E	541 205 2502	541 205 2504

#### CE certified models

Model	Handle
	Self return type (S)
F-22RCR-1S EC	541 207 1016
F-32RCR-1S EC	541 207 1024
FCD-75R-11S EC	541 207 1278
FCD-50R-11S EC	541 207 1260
FCD-32R-11S EC	541 207 1256
FCD-23R-12S EC	541 207 1252
FCD-23R-11S EC	541 207 1247
FCD-100R-11S EC	541 207 1238

For CE region availability of non CE models, please inquire to your Fuji representative.

#### NPT models

Model	Handle
	Self return type (S)
FCD-23R-11S N	541 205 2507
FCD-23R-12S N	541 205 2511
FCD-32R-11S N	541 205 2515
FCD-50R-11S N	541 205 2519
FCD-75R-11S N	541 205 2545
FCD-100R-11S N	541 205 2503

For possibility of NPT inlet for other models, please inquire to your Fuji representative.

DRILLS

ACCESSORIES

COLLET CHUCKS, SNAKE DRILLS, ATTACHMENT AND PADS FOR FCD-6A, 6B AND 6EX

COLLET CHUCKS

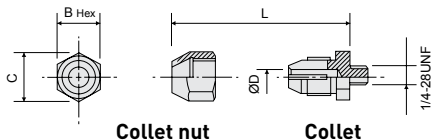

SNAKE DRILLS

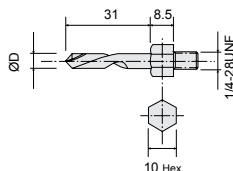

VELCRO RUBBER PAD

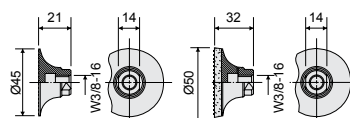

Item N°/ PN
MP-2-1
541 205 4843

Item N°/ PN
MP-2-1S
541 205 4844

Kit	Collet nut		Collet		Size					
	Kit N°	Part Number	Item N°	Part Number	D	B(Hex)	C	L		
CN-1802	541 205 1123	D-021343-00	541 207 0527	D-021342-00	541 207 0526	3	-	12	13.8	15
CN-1804	541 205 1125	D-023343-01	541 207 0537	D-023342-01	541 207 0532	4	-	14	16.2	21
CN-1806	541 205 1127	D-023343-01	541 207 0537	D-023342-02	541 207 0533	5	-	14	16.2	21
CN-1807	541 205 1128	D-023343-00	541 207 0536	D-023342-04	541 207 0535	6	-	17	19.6	23
CN-1808	541 205 1129	D-023343-00	541 207 0536	D-023342-00	541 207 0531	-	1/4	17	19.6	23

AC Number	Part Number	Size
		D
SN-2	541 205 8954	2
SN-3	541 205 8955	3
SN-4	541 205 8956	4
SN-5	541 205 8957	5
SN-6	541 205 8958	6

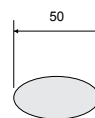

AC Number	Part Number	Grit #
MP-2-10	541 207 4556	40
MP-2-2	541 205 4845	60
MP-2-3	541 207 4557	80
MP-2-4	541 205 4846	100
MP-2-5	541 207 4558	120
MP-2-6	541 205 4847	150
MP-2-7	541 207 4559	240
MP-2-8	541 205 4848	320

\*Minimum order required : 100pcs. per item.

VELCRO SANDING PAPERS

STIRRING PROPELLERS

AC No. : AT-P01

For use with 10mm Drill Chuck

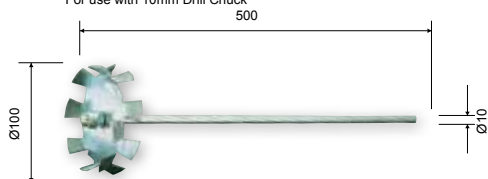

AC No. : AT-P02

For use with 13mm Drill Chuck

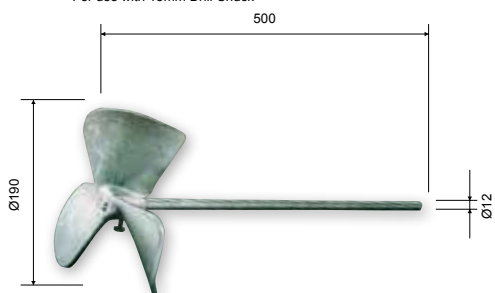

ADAPTERS TO CONNECT PROPELLERS TO DRILLS

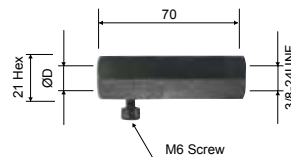

Item N°	Part Number	Size	stirring propellers Item	Part Number	Models
		D			
M-002693-01	541 205 4644	10	AT-P01	541 205 0902	FRD-5S, 6S-2-5
M-002693-00	541 205 4643	12	AT-P02	541 205 0903	5P, 8PX-1, 2

\*These adapters are designed to connect propellers directly to drills.

DEAD HANDLE FOR FRD-12Z, 16Z

Item No. : A-192014-00 / PN : 541 205 0777

This dead handle softens vibration and eases operator's fatigue much more than the ordinary dead handle.



Item N°	Part Number
A-192014-00	541 205 0777

STIRRING PROPELLERS

Stirring propellers attached to FRD series drills



SOFT JACKETS

- Soften vibration and Chill-touch
- Protect work piece and tool
- Improve comfort



Item N°	Part Number	Applicable Dia.	Thickness x Length
		mm	mm
SO-30	541 205 6241	26 - 33	2 x 120
SO-35	541 205 6242	34 - 42	
SO-55	541 205 6243	56 - 70	