

## HEAVY-DUTY CORNER DRILLS (NON-REVERSIBLE)



F-14CN



F-22RCN



F-32RCN

### GLOBAL SPECIFICATIONS

Model	Drilling Capacity		Reaming Tapping		Stall Torque		Free Speed	Socket	Side to Center		Feed Length		Power		Overall Length		Weight		Max. Air Consumption		Air Hose Size	
	mm	in	mm	in	N.m	ft.lb	min <sup>-1</sup>	M.T.#	mm	in	mm	in	W	hp	mm	in	kg	lb	m <sup>3</sup> /min	ft <sup>3</sup> /min	mm	in
F-14CN	14	9/16	9.5	3/8	31.4	23.1	1000	1	24	15/16	38	1.5	740	0.73	410	16.1	4.6	10.1	1.25	44.1	12.7	1/2
F-14CN-2	14	9/16	9.5	3/8	31.4	23.1	1000	2	24	15/16	38	1.5	740	0.73	410	16.1	4.6	10.1	1.25	44.1	12.7	1/2
F-22RCN	22	7/8	19	3/4	108	79.5	450	3	35	1 3/8	60	2.36	1100	1.48	493	19.4	8.5	18.7	1.50	53	12.7	1/2
F-32RCNS	32	1 1/4	25	1	127	94	400	3	40	1 3/5	25	0.98	1100	1.48	529	20.8	8.8	19.3	1.50	53	12.7	1/2

### TOOL SELECTION GUIDE

#### Standard models

Model	Handle	
	Normal roll handle	Self return type (S)
F-14CN E	541 205 2073	
F-14CN-1S		541 205 2074
F-14CN-2 E	541 205 2077	
F-14CN-2S		541 205 2078
F-22RCN E	541 205 2089	
F-22RCN-1S		541 205 2090
F-32RCN E	541 205 2106	
F-32RCN-1S		541 205 2107
F-32RCNS E		541 205 2110

#### CE certified models

Model	Handle
	Self return type (S)
F-14CN-1S EC	541 207 1001
F-14CN-2S EC	541 207 1003
F-22RCN-1S EC	541 207 1013
F-32RCN-1S EC	541 207 1020
F-32RCNS-1S EC	541 207 1022

For CE region availability of non CE models, please inquire to your Fuji representative.

#### NPT models

Model	Handle
	Self return type (S)
F-14CN-1S N	541 205 2075

For possibility of NPT inlet for other models, please inquire to your Fuji representative.

## HEAVY-DUTY CORNER DRILLS (REVERSIBLE)

Model	Drilling Capacity		Reaming Tapping		Stall Torque		Free Speed	Socket	Side to Center		Feed Length		Power		Overall Length		Weight		Max. Air Consumption		Air Hose Size	
	mm	in	mm	in	N.m	ft.lb	min <sup>-1</sup>	M.T.#	mm	in	mm	in	W	hp	mm	in	kg	lb	m <sup>3</sup> /min	ft <sup>3</sup> /min	mm	in
F-22RCR	22	7/8	19	3/4	93.2	68.7	400	2	35	1 3/8	60	2.36	900	1.2	505	19.9	8.5	18.7	1.50	53	12.7	1/2
F-32RCR	32	1 1/4	25	1	113	83.1	315	3	40	1 3/5	60	2.36	960	1.28	538	21.2	10	22	1.50	53	12.7	1/2
FCD-23R-12	22	7/8	19	3/4	80.4	59.3	430	2	27	1 1/16	35	1.38	900	1.2	472	18.6	7.1	15.6	1.50	53	12.7	1/2
FCD-23R-11	22	7/8	19	3/4	80.4	59.3	430	3	27	1 1/16	35	1.38	900	1.2	472	18.6	7	15.4	1.50	53	12.7	1/2
FCD-32R-11	32	1 1/4	32	1 1/4	177	130	350	3	35	1 3/8	53	1.38	1600	2.14	578	22.8	13.5	29.7	1.80	63.5	12.7	1/2
FCD-50R-11	50	2	50	2	392	289	140	4	41	1 5/8	58	1.38	1600	2.14	595	23.4	16	35.3	2.25	79.4	19	3/4
FCD-75R-11	75	3	75	3	834	615	85	5	49	1 15/16	57	2.24	1900	2.56	651	25.6	20.5	45.1	2.50	88.3	19	3/4
FCD-100R-11	100	4	100	4	1370	1013	40	5	62	2 7/16	105	4.13	1600	2.17	730	28.7	29.3	64.4	2.25	79.4	19	3/4



F-22RCR.S



F-32RCR.S



FCD-23R-50R.S



FCD-75R, 100R.S

### TOOL SELECTION GUIDE

#### Standard models

Model	Handle	
	Normal roll handle	Self return type (S)
F-22RCR-1S		541 205 2094
F-22RCR E	541 205 2093	
F-32RCR-1S		541 205 2115
F-32RCR E	541 205 2114	
FCD-75R-11 E	541 205 2544	541 205 2546
FCD-50R-11 E	541 205 2518	541 205 2520
FCD-32R-11 E	541 205 2514	541 205 2516
FCD-23R-12 E	541 205 2510	541 205 2512
FCD-23R-11 E	541 205 2506	541 205 2508
FCD-100R-11 E	541 205 2502	541 205 2504

#### CE certified models

Model	Handle
	Self return type (S)
F-22RCR-1S EC	541 207 1016
F-32RCR-1S EC	541 207 1024
FCD-75R-11S EC	541 207 1278
FCD-50R-11S EC	541 207 1260
FCD-32R-11S EC	541 207 1256
FCD-23R-12S EC	541 207 1252
FCD-23R-11S EC	541 207 1247
FCD-100R-11S EC	541 207 1238

For CE region availability of non CE models, please inquire to your Fuji representative.

#### NPT models

Model	Handle
	Self return type (S)
FCD-23R-11S N	541 205 2507
FCD-23R-12S N	541 205 2511
FCD-32R-11S N	541 205 2515
FCD-50R-11S N	541 205 2519
FCD-75R-11S N	541 205 2545
FCD-100R-11S N	541 205 2503

For possibility of NPT inlet for other models, please inquire to your Fuji representative.

DRILLS

ACCESSORIES

COLLET CHUCKS, SNAKE DRILLS, ATTACHMENT AND PADS FOR FCD-6A, 6B AND 6EX

COLLET CHUCKS

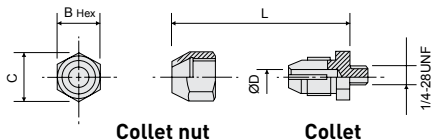

SNAKE DRILLS

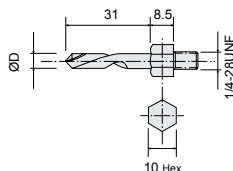

VELCRO RUBBER PAD

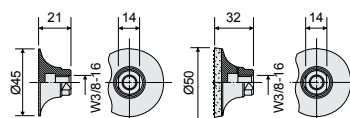

Item N°/ PN
MP-2-1
541 205 4843

Item N°/ PN
MP-2-1S
541 205 4844

Kit	Collet nut		Collet		Size					
	Kit N°	Part Number	Item N°	Part Number	D	B(Hex)	C	L		
CN-1802	541 205 1123	D-021343-00	541 207 0527	D-021342-00	541 207 0526	3	-	12	13.8	15
CN-1804	541 205 1125	D-023343-01	541 207 0537	D-023342-01	541 207 0532	4	-	14	16.2	21
CN-1806	541 205 1127	D-023343-01	541 207 0537	D-023342-02	541 207 0533	5	-	14	16.2	21
CN-1807	541 205 1128	D-023343-00	541 207 0536	D-023342-04	541 207 0535	6	-	17	19.6	23
CN-1808	541 205 1129	D-023343-00	541 207 0536	D-023342-00	541 207 0531	-	1/4	17	19.6	23

AC Number	Part Number	Size
		D
SN-2	541 205 8954	2
SN-3	541 205 8955	3
SN-4	541 205 8956	4
SN-5	541 205 8957	5
SN-6	541 205 8958	6

AC Number	Part Number	Grit #
MP-2-10	541 207 4556	40
MP-2-2	541 205 4845	60
MP-2-3	541 207 4557	80
MP-2-4	541 205 4846	100
MP-2-5	541 207 4558	120
MP-2-6	541 205 4847	150
MP-2-7	541 207 4559	240
MP-2-8	541 205 4848	320

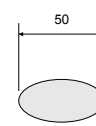

\*Minimum order required : 100pcs. per item.

VELCRO SANDING PAPERS

STIRRING PROPELLERS

AC No. : AT-P01

For use with 10mm Drill Chuck

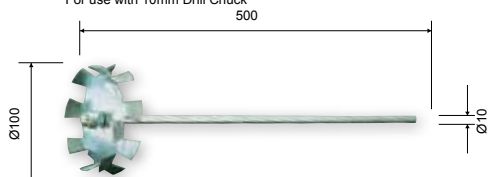

AC No. : AT-P02

For use with 13mm Drill Chuck

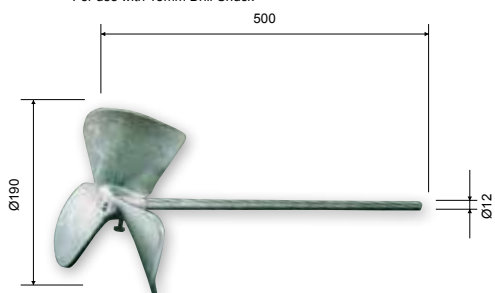

ADAPTERS TO CONNECT PROPELLERS TO DRILLS

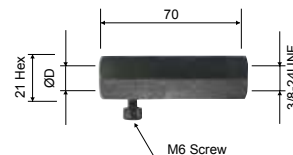

Item N°	Part Number	Size	stirring propellers Item	Part Number	Models
		D			
M-002693-01	541 205 4644	10	AT-P01	541 205 0902	FRD-5S, 6S-2-5
M-002693-00	541 205 4643	12	AT-P02	541 205 0903	5P, 8PX-1, 2

\*These adapters are designed to connect propellers directly to drills.

DEAD HANDLE FOR FRD-12Z, 16Z

Item No. : A-192014-00 / PN : 541 205 0777

This dead handle softens vibration and eases operator's fatigue much more than the ordinary dead handle.

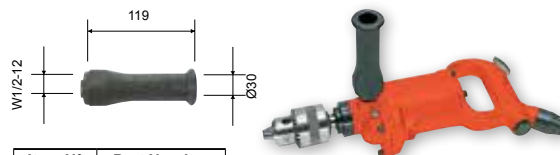

Item N°	Part Number
A-192014-00	541 205 0777

STIRRING PROPELLERS

Stirring propellers attached to FRD series drills



SOFT JACKETS

- Soften vibration and Chill-touch
- Protect work piece and tool
- Improve comfort



Item N°	Part Number	Applicable Dia.	Thickness x Length
		mm	mm
SO-30	541 205 6241	26 - 33	2 x 120
SO-35	541 205 6242	34 - 42	
SO-55	541 205 6243	56 - 70	